

TOTAL EXTENT (AS PER DOC.) : 6070 SQ.M ✓
 ROAD AREA : 1718 SQ.M ✓
 TOTAL NO. OF PLOTS : 40 Nos ✓
 CONVENIENT SHOP : 1 No ✓

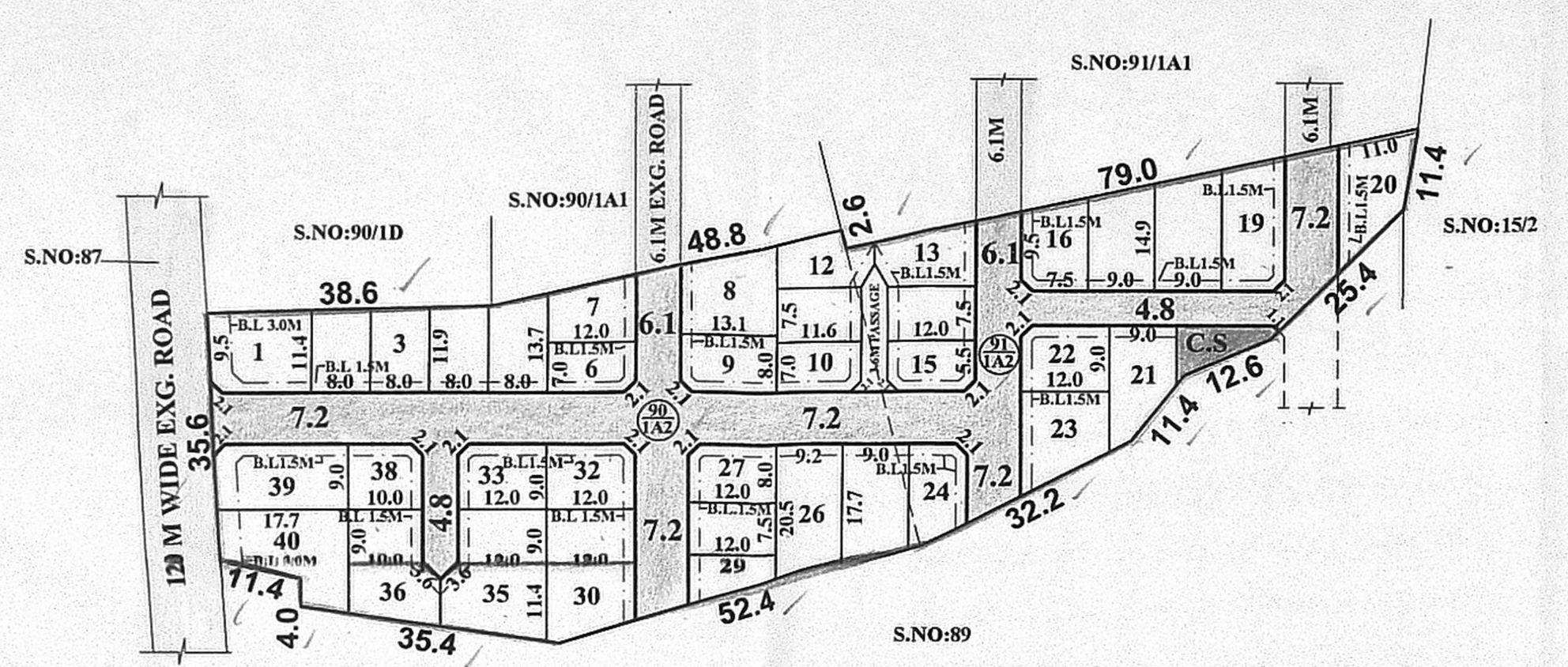

NOTE:
 1. SPLAY - 1.5M x 1.5M
 2. MEASUREMENTS ARE INDICATED EXCLUDING SPLAY DIMENSIONS
 3. ROAD AREA WAS HANDED OVER TO THE LOCAL BODY VIDE
 GIFT DEED DOC.NO: 121 / 2019, DATED: 08.01.2019 @ SRO, REDHILLS

CONDITIONS:
 DR RULE NO: 29 (11)
 THE COST OF LAYING IMPROVEMENTS TO THE SYSTEMS INRESPECT OF ROAD, WATER SUPPLY, SEWERAGE, DRAINAGE OR ELECTRIC POWER SUPPLY THAT MAY BE REQUIRED AS ASSESSED BY THE COMPETENT AUTHORITY, SHALL BE BORNE BY THE APPLICANT.

LEGEND:
 [Symbol] SITE BOUNDARY ✓
 [Symbol] ROADS GIFTED TO THE LOCAL BODY ✓
 [Symbol] EXISTING ROAD ✓
 [Symbol] CONVENIENT SHOP ✓

PREPARED BY P.A-IV (S.M) [Signature]
 CHECKED BY P.A.II (N.B.V) [Signature]
 A.P.(S.A) [Signature]

VILLIVAKKAM PANCHAYAT UNION
LAYOUT OF HOUSE SITES IN S.No: 90/1A2 & 91/1A2 OF POTHUR VILLAGE.

SCALE : 1:800 (ALL MEASUREMENTS ARE IN METRE)

CONDITIONS:
 THE LAYOUT APPROVED IS VALID SUBJECT TO OBTAINING SANCTION FROM THE LOCAL BODY CONCERNED.

P.P.D NO: 14
 L.O 2019
APPROVED
 VIDE LETTER NO : L1/15538/2018 ✓
 DATE : /02/2019

[Signature]
 FOR MEMBER SECRETARY
 CHENNAI METROPOLITAN
 DEVELOPMENT AUTHORITY

